

Floor Plan 1:100

ALL SIZES TO BE CHECKED ON SITE PRIOR TO ORDERING OR MANUFACTURING ANY MATERIALS.

All works and finishes to entire satisfaction of Client.
 All works to be in accordance with Building Regulations (Scotland) Act and all other legislation applicable in Scotland.
 No deviation to specification, structural or otherwise without consent from Architect / Structural Engineer.
 No part of works to encroach on site boundaries.
 All dimensions, heights, roof pitches etc. to be checked and confirmed prior to site start/ ordering of materials. Drawing not to be scaled. Drawing prepared for Planning/ Building Warrant purposes only, Client responsible for ensuring that all relevant applications sought. Drawing not to be taken as description of work/ complete specification for pricing
 Client to confirm with structural engineer structural stability of proposals.

Client to determine exact boundary positions and the location of existing services. New stair risers, goings, pitch etc. to be checked. Ground level to be altered if required to comply with position shown on Section. Approved drawings only to be referred to for information. Roof tiles to be suitable for roof pitch. Concrete foundations to be checked relative to particular ground conditions, as exposed prior to site start. Water Authority to be consulted regarding sewerage pipework. No works to be commenced until all approvals received and permission obtained for services connections/alterations as may be required.

DRAWINGS PREPARED FOR OBTAINING OF ALL APPROVALS AS MAY BE NECESSARY, NO RESPONSIBILITY WILL BE ACCEPTED IF PROPOSALS ARE REFUSED FOR ANY REASON.

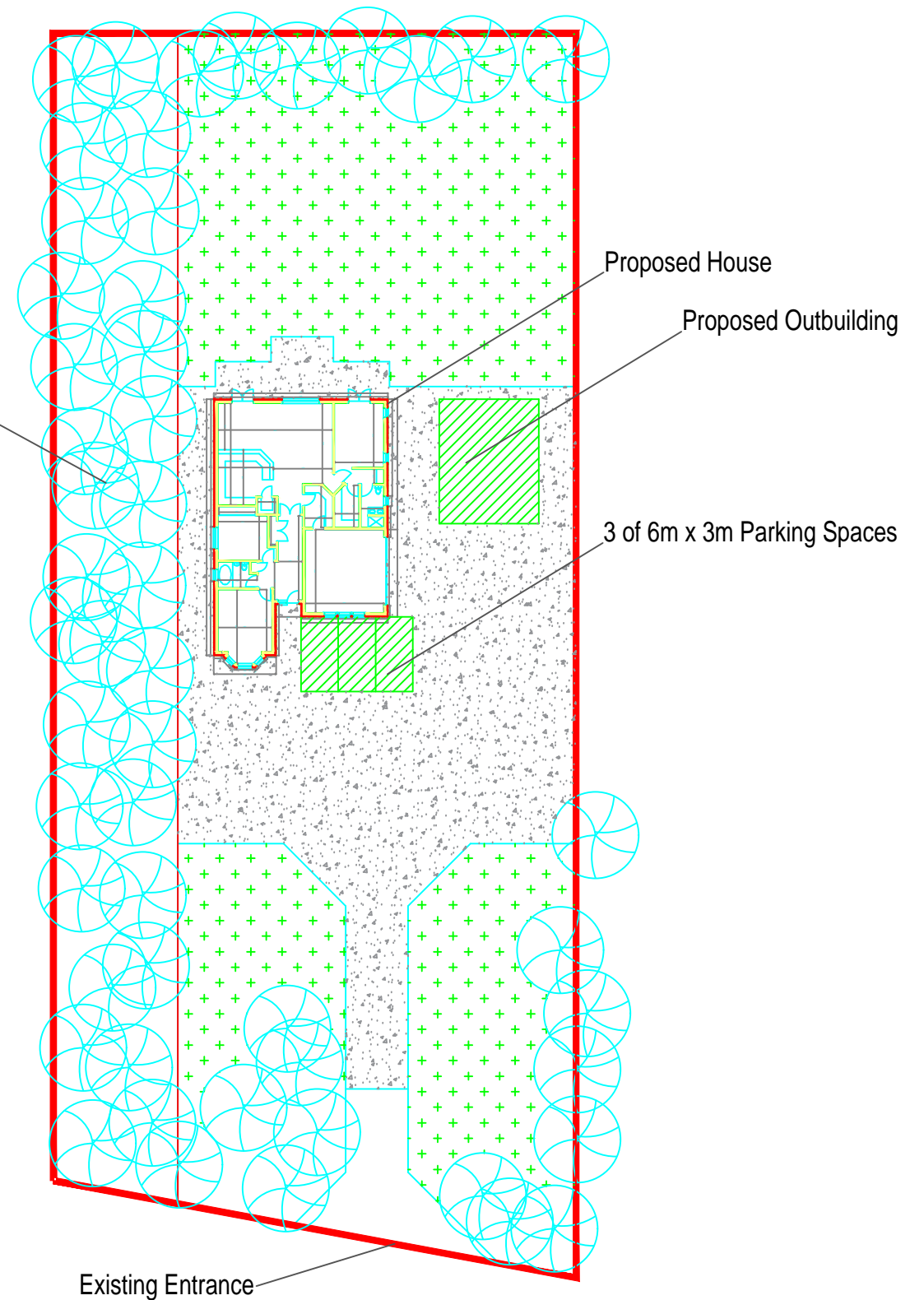

Proposed Site Plan 1/500

CS Plans Ltd.
 Udston Farm, Stonehouse, ML9 3PB, csplansltd@gmail.com
 07584309150, 07775706372

Avondyke Scouts	
Dykehead road	
Stonehouse	
Floor Plan	20-137-02
Scale 1:100 Print at A3	Dec 2020