

Planting Schedule

TREES

CODE	SPECIES	SPECIFICATION	GIRTH	HEIGHT	DENSITY	NUMBER
SaF	Sorbus aucuparia 'Fastigiata'	Heavy Standard: 5 brks: 3x: RB: Clear Stem 175-200cm	12-14cm	350-425cm	Counted	2 No.

ORNAMENTAL SHRUBS

CODE	SPECIES	SPECIFICATION	POT SIZE	HEIGHT	DENSITY	NUMBER
LaH	Lavandula angustifolia 'Hidcote'	Bushy: 5 brks: C	3L	20-30cm	3/m <sup>2</sup>	12 No.
RoMJU	Rosmarinus officinalis 'Miss Jessopp's Upright'	Bushy: 4 brks: C	3L	30-40cm	3/m <sup>2</sup>	6 No.
Soff	Salvia officinalis	Full Pot: C	3L	20-30cm	5/m <sup>2</sup>	22 No.
Tv	Thymus vulgaris	Full Pot: C	3L	20-30cm	4/m <sup>2</sup>	10 No.

Grass Seed Mixes

ECO SPECIES RICH LAWN (WFG20) FROM GERMINAL OR SIMILAR APPROVED

SPECIES	MIXTURE BREAKDOWN
Leontodon autumnalis	0.5%
Lotus corniculatus	0.5%
Medicago lupulina	1.0%
Agrostis capillaris	5.0%
Pimpinella saxifraga	0.2%
Hypochaeris radicata	0.2%
Festuca rubra commutata	10.0%
Centaurea nigra	2.0%
Cerastium fontanum	0.2%
Primula veris	0.1%
Agrostis stolonifera	2.5%
Ranunculus repens	2.3%
Taraxacum officinale	0.3%
Linum usitatissimum	1.2%
Galium verum	1.2%
Lolium perenne	2.5%
Silene dioica	2.0%
Trifolium pratense	2.0%
Plantago lanceolata	1.0%
Poa trivialis	5.0%
Prunella vulgaris	0.9%
Festuca ovina	20.0%
Festuca rubra litoralis	12.5%
Scabiosa columbaria	0.2%
Poa pratensis	5.0%
Festuca rubra rubra	15.0%
Phleum bertolonii	2.5%
Trifolium repens	2.0%
Daucus carota	1.0%
Teucrium scorodonia	0.5%
Achillea millefolium	0.5%
Rhinanthus minor	0.2%
Sowing rate 10 g/m <sup>2</sup>	

ALL PURPOSE LANDSCAPING (A19) FROM GERMINAL OR SIMILAR APPROVED

SPECIES	MIXTURE BREAKDOWN
Lolium perenne (Corail strong creeping red fescue)	25.0%
Festuca rubra rubra	35.0%
Agrostis castellana	5.0%
Festuca rubra litoralis	10.0%
Lolium perenne (Calico perennial ryegrass)	25.0%
Sowing rate 50 g/m <sup>2</sup>	

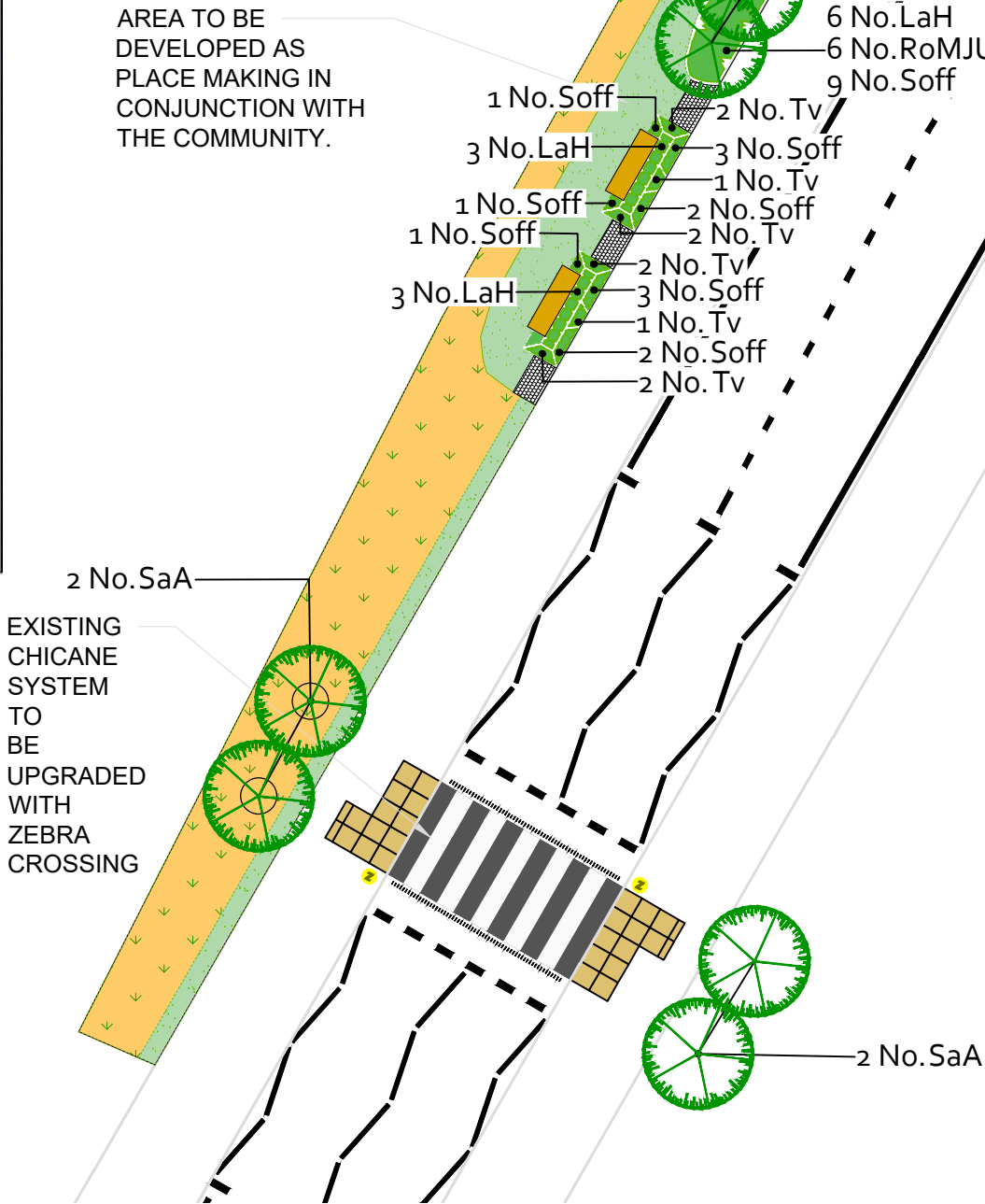

Legend



Proposed focal point tree planting (see planting schedule) (see drawing 1886 / o6 for detail)



Proposed focal point tree planting in 1m meter diameter weed free circles (see planting schedule) (see drawing 1886 / o6 for detail)

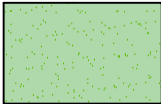

Proposed close mown grass (see planting schedule)

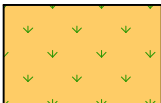

Proposed wild flower meadow (see planting schedule)



Proposed ornamental shrub planting (see planting schedule) (see drawing 1886 / o9 for detail)

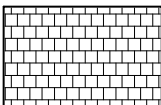

Proposed stone sett paving - 100x100x100mm Marshalls silver grey granite setts (or similar approved) (see drawing 1886 / o8 for detail)

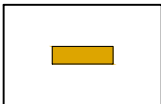

Proposed timber bench with armrest and back (to match existing)



General Notes

1. Prior to commencement of any work on site, protective fencing must be erected around existing trees to be retained in accordance with BS 5837:(2012).
2. Prior to any deep cultivation or excavation of planting pits the landscape contractor must check with the site manager / engineer for exact locations of any underground services.
3. Some tree positions may have to be amended to accommodate any amendments to locations of services.
4. For information on surface materials & details of hard landscape features such as walls & fences refer to architect's drawings.
5. For information on levels & drainage refer to engineer's drawings.
6. Limited information with regard to levels, drainage & underground services was available to us at time of preparation of drawing.
7. For Planting Notes and Maintenance & Management Proposals refer to separate A4 document.

Rev A: 18/12/2023 - Drawing updated following client comment. (MK)



Project: Culbokie Placemaking	Client: Pell Frischmann
Drawing Title: Placemaking Area 3 (Sheet 4 of 5)	
Scale: 1:200 @ A3	Date: 14 / 10 / 2022
Drawing No: 1886 / 04 Rev A	Status: Tender
Drawn by: C Corbett	Checked by: L Houghton



a: Dolphin House, 4 Hunter Square, Edinburgh, EH1 1QW  
t: 0131 357 3657 w: brindleyassociates.co.uk  
© Brindley Associates Ltd.