

Pride in Portbury

Portbury Parish Newsletter – Summer 2026



Bluebells in full bloom in Prior's Wood

Firstly, thank you for all the volunteers who helped to welcome our visitors into the village over the bluebell season: from cake bakers to cone layers and everyone who gave directions and smiled at people and made them welcome. It seems that the café at the church and signposted parking made the whole experience a lot more organised than in previous years!

Now we are (as I am writing!) sweltering in a heatwave ... oh no, sorry, downpours ... nope, back to sunshine! The planters are out around the village (thank you to the volunteers who have planted them and those who are keeping them watered). Please remember to keep your hedges trimmed back to keep footpaths clear – please let us know if you need any help with the upkeep!

Parish News

Annual Residents' Meeting – Saturday 22nd April 2026

This year, the meeting was held at 10am on a Saturday (rather than a weekday evening) to enable more villagers to attend and it was great to see so many attend. As with last year, a leaflet was produced to give out the key information so that the session could be more of a "Question and Answer" format. The information from the leaflet is reproduced at the end of this newsletter for anyone who missed it. Paper copies are available in the Village Hall clubroom.

Key news: flooding – after a lengthy search, the Parish Council have appointed a drainage expert who is now conducting a full survey of the rhines, drains, waterways and all other aspects of water in the village to advise on any future works and maintenance. More will follow but, as ever, the best approach is to ensure that drains and gulleys on our near your property are clear of leaves and litter. It is always more pleasant to do this in sunny weather than ankle deep in flood water!

Blister pack recycling box

Following the successful pilot of offering a recycling box for empty medical blister packs (which are not able to be recycled using other routes), the Parish Council will continue to fund this in 2026-2027. This box is available at the Village Hall. Please check there are no tablets left in the packets! If the box is full, please leave packets neatly in carrier bags and they will be added to a subsequent box when available.



Pride flag flying for Pride Month in June

Picture: Cath Campbell



Flooding outside the Village Hall (in 2024)

Picture: Barbara Langdon

Sheepway Bridges closure and transport

A major concern over the past few months for the Parish Council has been the work due to start this summer on the two “Brunel” bridges over the railway line. We have been notified that both bridges will need to be closed (one at a time) to be brought up to the appropriate safety levels to allow the new railway line to pass underneath. The Parish Council challenged the authority over how schoolchildren and residents at both ends of the Sheepway (particualry those from Elm Tree Park) would be able to safely access public transport during these two periods.

We are pleased to say we have now been informed that “a shuttle bus service will be provided whilst the Sheepway closure is in place. This shuttle will serve the stops at the end of Sheepway on Station Road (off the Portbury Hundred) between 7am and 7pm.

“During these hours, the shuttle will run between Sheepway stops (on Station Road) and Sainsbury’s in Portishead whilst providing a drop off and collection service to Gordano School in line with school start and finish times.

“For journeys out of Portishead towards Bristol, the X4 service will utilise the outbound bus stop on the Portbury Hundred with return journeys going through to Sainsbury’s and the shuttle service or return X4 route back to the Sheepway stops. This temporary arrangement ensures there are no pedestrians crossing the Portbury Hundred and as such the inbound stop on the Portbury Hundred will be suspended. Details of the timings, route map and process will be shared in due course.”

Parish Council meetings and vacancies: this is an opportunity to help to represent the views of the village. Everyone is welcome to attend meetings (1st Tuesday of the month in the Village Hall). Agendas are published one week before meetings and **only agenda items** can be discussed. Any member of the community may add items to the agenda prior to publication. Full details are on the Parish Council website, together with information about joining the council.

Port Velo Cycle Works Update

It's been a busy few months at Port Velo Cycle Works and we're pleased to share that work will soon begin on the next stage of our development.

The grant-funded fit-out will help us create a more welcoming and practical retail and service space, improving the experience for both existing customers and those discovering us for the first time. Alongside our workshop services, we have recently become official distributors for Officine Mattio, BH and Basso bikes and now offer a range of Ride to Work schemes, helping more people access cycling for commuting, leisure and fitness.

We'll be sharing updates as the project progresses over the summer and look forward to welcoming residents and visitors into the improved space in the coming months.

This project is funded by North Somerset Council, Portishead Town Council, and Together Portishead through the Portishead Economic Development Fund.



Traffic updates

As mentioned in the notes from the Residents’ Meeting, we have had several visitors to the village, including Sadik Al-Hassan MP, to look at the issues caused by what seems to be an increase in the volume and the speed of traffic through the village. We have also been using our speed check sign in create ways to gain robust data to present when looking at options to calm traffic through the village.

If you are willing to get involved to help reduce the speed of traffic in our village, please email simonp@portburypc.org.uk to find out how you can help.

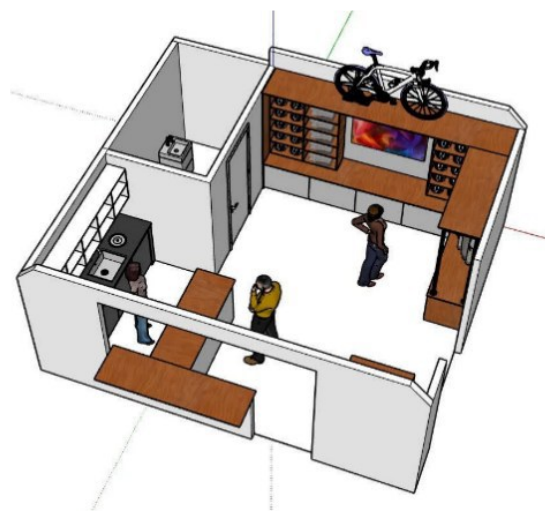

Pop and and check out how we are getting on. Or simply have a coffee and a chat!

See more at www.portveloworks.co.uk

A message from your MP – Sadik Al-Hassan

I am Sadik Al Hassan, and it is an honour to serve as the Member of Parliament for North Somerset. Before entering politics, I spent nearly 20 years working on the frontline of the NHS as a Pharmacist, including throughout the COVID 19 pandemic. That experience gave me a deep, first-hand understanding of the pressures facing patients and healthcare professionals alike. Seeing the decline in healthcare services up close was a key motivation for me to stand for Parliament, as I wanted to play my part in improving public services and raising living standards across our community.

Since being elected in 2024, my priority has been to listen carefully to residents and act on the issues that matter most to them. A major milestone has been helping to secure the future of the Portishead and Pill Railway Line. After sustained engagement with stakeholders and government ministers, I successfully secured £27 million in government funding in July 2025 to close the remaining gap and enable construction to begin plus a recent amount to cover inflation.

Improving access to healthcare locally has also been a central focus. Following the collapse of the Jhoots pharmacy provision in Portishead, I worked to ensure that Portishead residents were not left without vital services, securing the opening of two new pharmacies to restore local access.

Being an accessible and responsive local MP is at the heart of how I work. I regularly hold constituency surgeries, street surgeries, visit schools, businesses and community groups, and spend time speaking directly with residents across North Somerset.

If you would like to meet with me, please do get in touch. In addition to in-person constituency surgeries, I offer virtual appointments to ensure everyone can access support. I can assist with a wide range of personal issues, including education (including SEND), housing, government departments and public services, or you may wish to share your views on our local area, and what is important to you.

For more information about how I can help, please visit my website.



Sadik Al-Hassan on a recent visit to Portbury



St Mary's Primary School

Congratulations to all of our students for successfully completing their SATs last term. We are incredibly proud of their determination and positive attitude they have shown throughout the year. It has also been wonderful to see the children balancing their learning with so many enjoyable experiences across the term. From taking part in Wellbeing Week activities to working together in class, on the playground and during special events, the children have shown enthusiasm, resilience and kindness every step of the way.

We had a fantastic **Health and Wellbeing Week** with so many wonderful, extra activities for the children to enjoy, including sports sessions led by the coaches from Premier Education, pattern printing, making clay bird feeders, and smoothie tasting with Mrs Rose and Mrs Blundell, and reading for pleasure with Miss Massey. To round off the week, the children have had the special treat of yoga and sound bath sessions led by the lovely Annie Leith. It has been fantastic to enjoy the amazing buzz. Well done to all the staff for making it happen!

Summer events at St Mary's Church

FAB TWINS

As they prepare for playing at International Beatlesweek in Liverpool, The Fab Twins are back with a great mix of 60's music.

Sat 20th June at 7.30pm (doors open 7pm)

Tickets £12 (under 16s free) price includes your first drink. You can buy your tickets on the door or send Julie a message on 07791 664049

Every Wednesday is Open House at the church 10am - 1pm - come along for a cuppa and a bit of company, to find out more about local history, to share ideas or find out what's going on or how to get involved with some of our community projects. Particularly we are looking for anyone who is keen about nature and would like to help us design and develop a wellbeing, kind to nature community space that will be open 24/7 for the community to enjoy.

On the 1st Wednesday of every month you are welcome to join us for a soup lunch. Home made tasty soup with a bread roll and a lovely chat over lunch. It's free, but any donations to help cover costs are much appreciated.

4th July is our HeARTs café 10am - 1pm The last one before our August break. We'll be back on 5th September with lots of happy creative fun for the kids with Happy HeARTs with Jo Green. Lots of positivity and arty exploration plus they learn about nature too with our new nature journalling.

We have a great community space and would love to share it with other community groups. We'd particularly love to get something musical up and running. Maybe you are in a choir or a band or run a business looking for a space to perform or hold talks or training sessions. Come and have a look - the acoustics and facilities are great.

If you'd like to know more, please get in touch with our Churchwarden Ann Longstaff on 07552 629928 or Church Secretary Julie Mainstone on 07791 664049

There is a church service most weeks - Holy Communion on the 2nd and 4th weeks - there is just an occasional week when we get together with our sister churches at Easton in Gordano or Pill.

Follow our facebook page 'Hearts at Portbury' for more details of all our events.



Portbury Village Hall and Social Club

Over the past year, we have continued to renovate and update the Village Hall with full redecoration and investment in new resources for events. As well as a weekly programme of events for members of the village (and beyond) we are receiving a greater number of bookings for parties, weddings and conferences. See our website for more details.

Each week, the clubroom bar is open on Fridays and Sundays from 7.30pm. Additionally, over the summer, come and join us for the Summer Skittles competition: seven village teams battle it out every Wednesday, Thursday and Friday from 8.00pm.

At Christmas (yes – that’s on the horizon!) don’t miss out on our festive evenings, including the Pill Owls with their traditional Victorian carol concert on Christmas Eve!

We also have live music coming up:

Scott Doonican – lead singer of the Barsteward Sons of Val Doonican (festival favourites) – a genuinely side-splitting musical comedy act – **Saturday 13th June**. Limited tickets still available from www.thebarstewardsons.com/tour - you do not want to miss this epic night!

Hooper – “Bristol’s Best Cover Band” – a loud and frenetic night of fantastic covers. Hooper are returning to the Village for the first time in 5 years and this will be a classic Portbury night out- Saturday 25th July Tickets are £5 but free for members – [click here to secure your tickets](#).

Saphi – the brilliant singer/songwriter Sophie Holliday is coming back to the Hall for a third time. Genuinely talented with an ability to read and respond to a crowd like few others. Saturday 9th September - tickets for this gig are also free for members of the Village Hall (£5 non-members) [Click here for tickets](#).

Also coming soon:

Community Café – our popular Community Café events will be running again from 10-12pm on **Saturday 27th June** and **Saturday 21st November**. Please contact admin@portburyvh.org.uk if you would like a stall. As well as fresh coffee and breakfast sandwiches, there will be a great range of local products and a chance to sit and have a chat with friends and neighbours, old and new.

Cheese and Wine Evening – Festive Fizz (Saturday 5th December)

Tickets are already going fast for this and it will be another wonderful event where you can learn more about fizzy wines and special cheeses – and also enjoy a drink and some fun with friends!

Quiz Nights, Rock n Roll Bingo – look out for further details on the **Village Hall Facebook and Instagram pages**.

Membership is only £10 for individuals, £5 for Seniors and £20 for a household and also includes 10% off purchases at the bar and hall hire too! As a volunteer organisation, we are always looking for new recruits – come and ask how you can get involved!



The hall dressed for a recent wedding



An evening of musical comedy with the frontman of
THE BAR-STEWARD SONS OF VAL DOONICAN

SCOTT DOONICAN

'Always enjoy the boys from The Bar-Steward Sons of Val Doonican... Great fun'
- Jason Manford, comedian

'The greatest thing to come out of Barnsley, since the A61 to Sheffield' – Jarvis Cocker, musician

'There's no chance you'll ever get him to play at Portbury Village Hall' - Anon

SAT 13TH JUNE
ONE MAN SHOW: BRISTOL
PORTBURY VILLAGE HALL BS20 7TW

TICKETS: www.thebarstewardsons.com/tour



Hire the Hall, Club room or whole facility for your next event:
www.portburyvh.org.uk or email bookings@portburyvh.org.uk

Local Oasis tribute Definitely Noel
performing at the Village Hall in May

Portbury WI – 3rd Tuesday of the month (not August) at 7.30pm - Village Hall

You don't have to:

- Knit, sew or crochet
- Bake cakes or make jam
- Wait until you retire or 'be a certain age'
- Craft, read lots of books, sing Jerusalem, like walks or drink tea

To join Portbury WI

If you are a woman of any age wanting to make new friends and learn new things you will be welcome at our meetings. With around twenty members from the Portbury and Portishead area we are a friendly group of women keen to welcome new members. We enjoy monthly meetings with speakers/demonstrations/activities. Monthly walks and lunches, social events and outings we organise ourselves, plus attending talks, quizzes, outings and craft classes etc. run by Avon Federation of WIs.

Monthly meetings are on the 3rd Tuesday (not August)

7.30pm - 9.30pm at Portbury Village Hall (side entrance)

Our next meeting is a social event with food on Tuesday 16 June to celebrate Portbury WI's 92nd birthday. If you'd like to come along and meet us, please give Helen a call on 07503 134817.

Help Us Support Young Adults Living With Epilepsy

The Bristol Epilepsy Social Group is a group for young adults with epilepsy and their parents/carers. It provides friendship, support, and opportunities for people who can often feel isolated or misunderstood because of their condition.

The group meets at the Long Ashton Community Centre twice monthly offering a safe and welcoming space where members can meet others with shared experiences, enjoy social activities and build confidence and lasting friendships. For many, it's one of the few places where they truly feel understood.

We are now seeking support from local businesses and members of the community to help us continue and grow this valuable work. Donations or sponsorship would help fund venue hire, activities, refreshments and further promotion. Even small contributions can make a real difference.

If you are a local business interested in supporting young adults living with epilepsy and their parents, we would be delighted to hear from you. Your support would directly help create opportunities, friendships, and greater independence for young people in our area. To find out more or offer support, please contact: Corina Reay - newleaveturned@gmail.com. Feel free to leave your phone number and I will happily call you for a chat.

If you'd like to attend the group yourself, new members join all the time so you won't be alone! Bring a friend if this would help. We are all super friendly and relaxed and it's free to join! Please contact Corina for more information. Details are also held on the Epilepsy Action website 'support groups' pages for Bristol www.epilepsy.org.uk

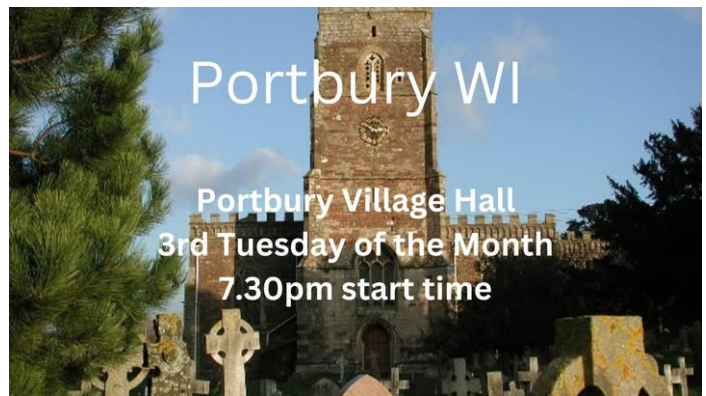

Thank you for taking time to read the newsletter. If you would like to contribute to the next edition, please email crisc@portburypc.org.uk – we are always looking for news on what is going on and in organisations or businesses in the area who would like to get messages out to the villagers of Portbury.

Have a lovely summer!

Portbury Parish Council Annual Resident's Meeting – Handout from meeting

(PLEASE NOTE – there may have been further developments since publication – see above)

Saturday 25th April 2026

Key Updates – Cllr Cowlard

Since the last Resident's Meeting, the PPC Meetings have seen lots of activity with key outcomes for the Parish. PPC have continued to invest in the young people in the Parish with renovating the children's play area in the playing field, which has seen many improvements including the provision of a new zip wire.

There have also been meetings with various bodies regarding issues that have a direct impact on the lives of those people living and working in the Parish. These have included:

- Further consultation on the Bus Lane Improvement Plan on the A369 and changes to the junction between the High Street and the A369.
- Meeting the new CEO of NSC Mandy Bishop where several issues pertinent to Parish Life were brought up. Traffic, flooding, planning and communication with NSC were all raised in a frank and productive meeting
- Meeting with the Highways Agency regarding the J19 Bridge Strengthening
- Meeting Network Rail and NSC to discuss issues with the closure of the Sheepway to facilitate bridge works. PPC are committed to ensuring that the provision of safe journey options to school for the children of the Parish, and the continued delivery of a bus service for the residents of the Sheepway are uppermost in the planning of any works.
- Meeting and regular communication with the local MP, to keep the Parish's priorities high on his agenda. This will be followed up by a visit from him in May.

The PPC is still facing challenges, and will continue to campaign on and keep a watching brief on some key local issues. Currently we are focused on:

- NSC Devolution, which will see responsibility for some local services be handed to Parish Councils (without any additional funding)
- Port growth into the Sheepway, Bristol Port Company are seeking to expand their car parking spaces into land that they own adjacent to the Sheepway. The PPC are monitoring how this is developing

Traffic & Transport – Cllr Penn

Traffic issues have been an agenda item at every meeting, PPC (assisted by residents) have been working to keep this item at the top of NSC's agenda. Since the last residents' meeting, the village speed camera has been helping to log volume and speed of traffic.

Between 12 Jan and 23 Mar 2026, traffic speeds and volumes were monitored at three points in the village: Mill Lane, Caswell Lane and High Street:

Speed data overview

Location (date)	Direction of travel	Vehicles per day	Av. Speed (mph)	Speed distribution			Max Speed (mph)
				≤20-mph	21-30 mph	≥31-mph	
Mill Lane (12 – 25 Jan)	Incoming	3494	20.5	62.7%	34.7%	2.6%	49
	Outbound	3155	22.8	39.8%	54.9%	5.3%	50
Caswell Lane (27 Jan - 8 Feb)	Incoming	406	17.8	76.3%	23.2%	0.5%	50
	Outbound	574	18.3	73.9%	25.3%	0.8%	44
High St (10 - 22 Feb)	Incoming	3844	21.9	53.9%	40.2%	5.9%	58
	Outbound	3730	24.1	30.7%	62.8%	6.5%	59
Caswell Lane (24 Feb – 8 Mar)	Incoming	392	18.7	71.6%	27.2%	1.2%	42
	Outbound	788	20.3	57.0%	41.5%	1.5%	59
High St (10 – 23 Mar)	Incoming	3349	22.6	45.3%	49.4%	5.3%	53
	Outbound	4452	21.4	54.2%	43.6%	2.2%	57

Key: Incoming: Cars driving into the village; Outbound: Cars driving out of the village.

Key stats:

Traffic volume:

- Daily traffic decreased compared to Sep/Oct 2025 at Mill Lane (7598 → 6649) and Caswell Lane (1414 → 980/1180).
- High Street remains steady at approx. 7500–8000 cars per day.

Speed:

- Average speeds range from 18–24 mph, highest on High Street outbound (24.1 mph).
- Up to 6% of drivers exceed 31 mph, with some reaching dangerous speeds.

If anyone would like to discuss these stats, or help collect, analyse, and share traffic data, please contact simonp@portburypc.org.uk

Planning – Cllr Chilcott

Since the last resident’s meeting, there have been planning items on every PPC agenda, whether new applications or updates on existing plans.

2025							2026			
Jun	Jul	Aug	Sep	Oct	Nov	Dec	Jan	Feb	Mar	Apr
3	1	0	1	2	3	0	0	0	0	

Of these applications, PPC maintains a neutral position on most applications unless there are significant issues with the application (e.g. Green Belt, detrimental impact on local infrastructure etc.) where we will make a comment on the application.

These comments will then inform NSC’s position on accepting or refusing the application.

During the year, the PPC have objected to 2 developments, 1 has seen planning refused, the other has had No Further Action.

Environment – Cllr Chilcott

Flooding has again proved to be an issue that concerns parishioners. Since the last Resident’s meeting, the PPC have managed to secure the services of a drainage expert, who has done an initial survey and quoted for a full survey. PPC had ringfenced monies for this vital work to take place which when completed will give a much clearer overview of where the water drains (or doesn’t!)

Village Hall Liaison – Cllr Campbell

Since the last Resident's meeting, the Community Café has been re-established. The Village Hall is run by volunteers - we are always looking for new faces and ideas!

The village newsletter is a continues to be published quarterly informing the Parish as to what is going on. Please contact CrisC@portburypc.org.uk to pass on stories and information. If you represent an organisation with links to the village, please get in touch to become a regular contributor

Other PPC roles

Village Lengthsman

Kevin Weekes is currently our Village Lengthsman. Under the auspices of the PPC, the past year has seen Kevin:

- Supply and Erect the Village Green Christmas Tree
- Undertake playground inspections on a weekly and monthly basis
- Undertake repairs to playparks equipment
- Cutting the grass at playparks
- Emptying and disposing the contents from the dog poo bins
- Undertake some litter/flytipping collection
- Cut back any overgrowth (not including residential properties)
- Keeping walkways clear including the path to St. Mary's school
- Ensure that all signage is visible
- Remediating the Village Green Sinkhole

Kevin will continue to fulfil these duties and any other maintenance issues he can deal with.

And Lastly!

Would you like to have a say in how things are done and what the local Parish Council monies are spent on? Do you like to see the village looked after, planters maintained, benches, bins and play areas cared for? Do you enjoy visiting Prior's Wood, seeing the bluebells. Do you enjoy walking through the playing fields and seeing the children playing in the play area?

Without Parish Councillors and those supporting and maintaining all of the above, the parish would not be the pleasant place it is today. We NEED new people to join the friendly Parish Council and help us with keeping the parish a great place to live, work and play in.

Becoming a Parish Councillor is an opportunity to influence both the short and long term development of the parish of Portbury and to represent the views of all residents within the Parish. If you need to know more ask one of the councillors.